

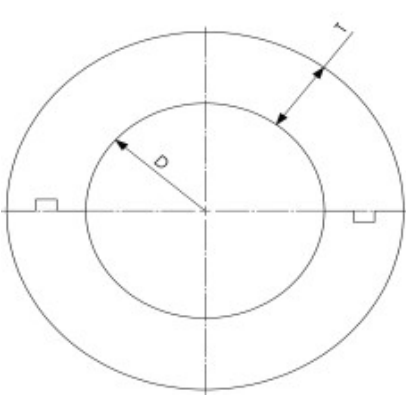

RUBBER SUPPORT INSERTS FOR GI PIPES



FEATURES AND BENEFITS.

Description:-

- * Used at the supporting points of insulated pipes to prevent crushing of insulation.
- * Very high load bearing capacity.
- * Dimensionally accurate as piece is moulded.
- * Excellent resistance to deterioration/ distortion.

Special:-

- * Density:- 1100 - 1600 kg/m³
- * Thermal Conductivity :- 0.16 w/m Temperature
- * Resistance from -20 °C to + 110 °C
- * Designed to meet BS3974-1 : 1974

Standard B Dimension

Upto 2"	:- 25 mm
2 1/2" to 5" 6"	:- 38 mm
and Above	:- 50 mm

Sr. No.	Nominal Pipe Size		Pipe OD (D) mm	(T) 13MM	(T) 19mm	(T) 25mm	(T) 32mm	(T) 38mm	(T) 50mm	(T) 65mm	(T) 75mm
	In.	mm									
1	1/2"	DN15	21.3	VT13RSI022	VT19RSI022	VT25RSI022	VT32RSI022	VT38RSI022	VT50RSI022	VT65RSI022	VT75RSI022
2	3/4"	DN20	26.7	VT13RSI028	VT19RSI028	VT25RSI028	VT32RSI028	VT38RSI028	VT50RSI028	VT65RSI028	VT75RSI028
3	1"	DN25	33.4	VT13RSI034	VT19RSI034	VT25RSI034	VT32RSI034	VT38RSI034	VT50RSI034	VT65RSI034	VT75RSI034
4	1 1/4"	DN32	42.1	VT13RSI042	VT19RSI042	VT25RSI042	VT32RSI042	VT38RSI042	VT50RSI042	VT65RSI042	VT75RSI042
5	1 1/2"	DN40	48.2	VT13RSI048	VT19RSI048	VT25RSI048	VT32RSI048	VT38RSI048	VT50RSI048	VT65RSI048	VT75RSI048
6	2"	DN50	60.3	VT13RSI060	VT19RSI060	VT25RSI060	VT32RSI060	VT38RSI060	VT50RSI060	VT65RSI060	VT75RSI060
7	1 1/2"	DN65	73	VT13RSI073	VT19RSI073	VT25RSI073	VT32RSI073	VT38RSI073	VT50RSI073	VT65RSI073	VT75RSI073
8	3"	DN80	88.9	VT13RSI090	VT19RSI090	VT25RSI090	VT32RSI090	VT38RSI090	VT50RSI090	VT65RSI090	VT75RSI090
9	3 1/2"	DN90	101.6	VT13RSI102	VT19RSI102	VT25RSI102	VT32RSI102	VT38RSI102	VT50RSI102	VT65RSI102	VT75RSI102
10	4"	DN100	114.3	VT13RSI114	VT19RSI114	VT25RSI114	VT32RSI114	VT38RSI114	VT50RSI114	VT65RSI114	VT75RSI114
11	5"	DN125	141.3	VT13RSI141	VT19RSI141	VT25RSI141	VT32RSI141	VT38RSI141	VT50RSI141	VT65RSI141	VT75RSI141
12	6"	DN150	168.3	VT13RSI168	VT19RSI168	VT25RSI168	VT32RSI168	VT38RSI168	VT50RSI168	VT65RSI168	VT75RSI168
13	8"	DN200	219.1	VT13RSI219	VT19RSI219	VT25RSI219	VT32RSI219	VT38RSI219	VT50RSI219	VT65RSI219	VT75RSI219
14	10"	DN250	273.1	VT13RSI273	VT19RSI273	VT25RSI273	VT32RSI273	VT38RSI273	VT50RSI273	VT65RSI273	VT75RSI273
15	12"	DN300	323.8	VT13RSI323	VT19RSI323	VT25RSI323	VT32RSI323	VT38RSI323	VT50RSI323	VT65RSI323	VT75RSI323
16	14"	DN350	355.6	VT13RSI356	VT19RSI356	VT25RSI356	VT32RSI356	VT38RSI356	VT50RSI356	VT65RSI356	VT75RSI356
17	16"	DN400	406.4	VT13RSI406	VT19RSI406	VT25RSI406	VT32RSI406	VT38RSI406	VT50RSI406	VT65RSI406	VT75RSI406
18	18"	DN450	457.2	VT13RSI457	VT19RSI457	VT25RSI457	VT32RSI457	VT38RSI457	VT50RSI457	VT65RSI457	VT75RSI457
19	20"	DN500	508	VT13RSI508	VT19RSI508	VT25RSI508	VT32RSI508	VT38RSI508	VT50RSI508	VT65RSI508	VT75RSI508
20	24"	DN600	609.6	VT13RSI610	VT19RSI610	VT25RSI610	VT32RSI610	VT38RSI610	VT50RSI610	VT65RSI610	VT75RSI610

NOTE:-

- NON STANDARD WIDTH ARE ALSO AVAILABLE, THE SIZES LISTED ABOVE ARE OUR STANDARD SIZES, WE ALSO MAKE CUSTOM SIZES.
- WE ALSO MAKE ALL CLAMPS TO FIT ABOVE RSI, LIKE CLEVIS HANGER, SPRINKLER HANGER, U STRAP, U BOLTS, NUT CLAMPS & ETC.

