

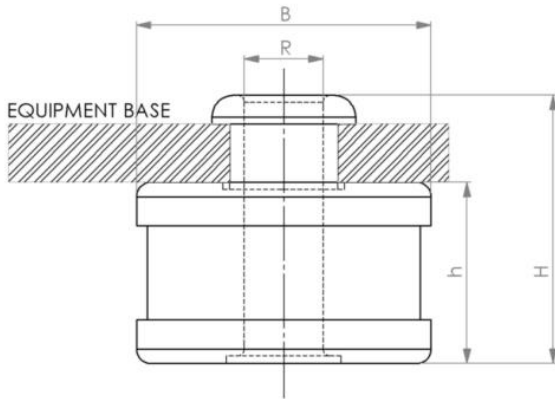

DUCT MOUNT



FEATURES AND BENEFITS.

- Description:-**
- * Duct Hanger consist of a resilient rubber mount held between two plated steel caps.
 - * For uniform distribution of load. It has an integral extended rubber sleeve which prevents direct.
 - * Metal-to-metal contact, thereby minimizing transmission of noise and vibration.

TYPICAL APPLICATIONS

SUSPENSION OF

- * Fan Coil Units
- * Pipes
- * Ducts
- * Brackets
- * Light Weight Equipment

FLOOR MOUNTING OF

(using rubber element only)

- * Refrigerators
- * Domestic Appliances
- * Industrial Equipments

Product Code	B mm	H mm	h mm	R mm	Deflection mm	Max Load (N)
VTDM9	41	37	25	M10	4	900
VTDM6	32	27	19	M10	4	600

- NOTE:-**
1. DUE TO POLICY OF CONTINUAL IMPROVEMENT, THE SPECIFICATIONS ARE SUBJECT TO CHANGE WITHOUT PRIOR NOTICE.
 2. MEASUREMENT ARE SUBJECT TO 5% TOLERANCE.
 3. TO ACHIEVE GOOD SOUND SUPPRESSIONS DO NOT LOAD FITTING.

